



## A Series Pallet Truck Mini Range II

with capacities of 1,500kg

The A series pallet truck mini range II has been engineered to be both powerful and flexible to meet the requirements of many demanding applications. Whether it's supermarket work, delivery service, stock replenishment or heavy manufacturing, the A series pallet truck mini range II has the strength and durability to minimise your total cost of ownership.

### Appearance

- / A series pallet truck mini range II applied professional industrial design, stream lines, and compact, and fully ergonomic consideration, in line with the latest design trends.
- / Applied steel stamping and injection molding processes, which is robust, durable, and also environmental compliance.

### High Performance

- / Rated capacity 1500kg, meet the needs of the majority of customers.
- / Powered by traction motor not only has good acceleration and perfect performance, but also low heat.
- / Latest CURTIS control system, precise and smooth.
- / Regenerative braking for battery recovery during travel speed reduction, anti-slope on gradient.
- / All key parts such as tiller, switches, connectors, battery indicator and hour meter all adopt the famous brand.

### Reliability

- / 5-pivot design provide longer working life.
- / Imported waterproof connectors, all wires and cables are protected, greatly improve the reliability of the electric system.
- / Top quality hydraulic power unit applied to provide low noise, low vibration, smooth lifting and landing reliable operation.
- / Punch formed forks to provide more strength and tip guide to provide higher efficient operation.
- / Using non-contact proximity switch, improves safety and reliability.

### Safety

- / Three braking system of regenerative braking, reverse current braking, parking brake, insures the safe operation.
- / Anti-slope on gradient can keep the safety.
- / The emergency button on the tiller head can effectively avoid the harm to the driver.
- / The standard equipped electronic lifting limitation protect the pump motor from damaging dramatically and more energy saving.



Rema tiller head



Auxiliary wheels are equipped to have better stability



Modern outline design



Tandem load wheel

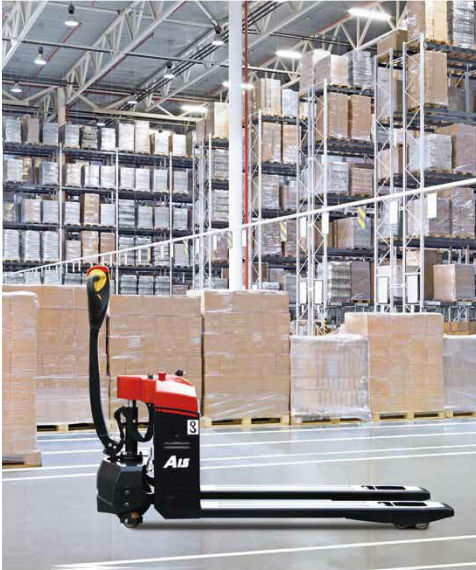

## Standard Specification

- / Permanent magnet drive motor
- / CURTIS permanent magnet controller
- / HPI hydraulic unit
- / Emergency switch
- / Multi-function battery indicator
- / PU wheel
- / 1150mm fork length
- / 560mm outside fork width
- / Electronic lifting limitation
- / Non-contact proximity switch
- / Tiller made by REMA
- / Horn
- / Maintenance free battery
- / Internal charger
- / Walking upright
- / Guide device
- / Additional wheel
- / Tandem load wheel

## Options

- / Different length of fork
- / Different width of outside fork
- / Single load wheel

## Comfort

- / Simple and beautiful tiller made by REMA designed to make the operator feel comfortable, all the operation can be completed by one hand.
- / Optimized designing structure to offer a good visibility and easy entrance of the pallet.
- / Built-in charger and maintenance free gel battery adopted to provide convenient usage.
- / The compact body and semicircular design provide an ideal operation in limited space, and the ability of walking upright greatly increases the convenience in the container.
- / Standard fork height 80mm, equipped the guide device easy to get in pallets (including sealing pallets).
- / Side battery change is standard feature.

## Maintenance

- / Built-in charger and maintenance free gel battery, you don't need to worry about them.
- / Integrated battery indicator, hour meter and self-diagnostic instrument.
- / Full opened hood, easy accessibility of all components, is easy for service.
- / All shafts installed lubricated shaft sleeve and oil cup, provide convenient maintenance and long service life.



## A Series Mini Range Pallet Truck II

Distinguishing mark	1.1	Manufacturer	HANGCHA GROUP CO.,LTD.
	1.2	Manufacturer's type designation	CB015-A2M1
	1.4	Operator type: hand, pedestrian, standing, seated, order-picker	Pedestrian
	1.5	Rated capacity/rated load	Q (kg/lb)
Weight	1.6	Load centre distance	c (mm/in)
	1.8	Load distance, centre of drive axle to fork	x (mm/in)
Tyres chassis	1.9	Wheelbase	y (mm/in)
	2.1	Service Weight(Including battery)	kg/lb
		Battery weight	kg/lb
	3.1	Tyres: solid rubber, superelastic, pneumatic, polyurethane	PU
	3.2	Tyre size, front	mm/in
	3.3	Tyre size, rear	mm/in
	3.4	Additional wheel (dimensions)	mm/in
	3.5	Wheels, number front / rear (x = driven wheels)	1x+2/4
	3.6	Tread, front	b10 (mm/in)
	3.7	Tread, rear	b11 (mm/in)
Dimensions	4.4	Lift	h2 (mm/in)
	4.15	Fork height,lowered	h13 (mm)
	4.19	Overall length	l1 (mm/in)
	4.21	Overall width	b1 mm (in)
	4.22	Fork dimensions	s/e/l mm (in)
	4.25	Distance between fork-arms	bs mm (in)
	4.32	Ground clearance, centre of wheelbase	m2 (mm/in)
	4.34.1	Aisle width for pallets 1000 x 1200 crossways	Ast (mm/in)
	4.34.2	Aisle width for pallets 800 x 1200 lengthways	Ast (mm/in)
	4.35	Turning radius	wa (mm/in)
Performance data	5.1	Travel speed,laden/unladen	km/h (mph)
	5.2	Lift speed,laden/unladen	m/s (ft/min)
	5.3	Lowering speed,laden/unladen	m/s (ft/min)
	5.8	Max Gradeability,laden/unladen	%
Electric engine	6.1	Drive motor rating 52 60 min	kW/hp
	6.2	Lift motor rating at 53 15%	kW/hp
	6.4	Battery voltage,rated capacity	V/Ah
	8.1	Type of drive control	DC
	9.1	Manufacturer	Curtis

Note: 1) VDI 2198: +358/14.1mm/in 2) VDI 2198: +200/7.9mm/in 3) When fork lowered.+60/2.4mm/in

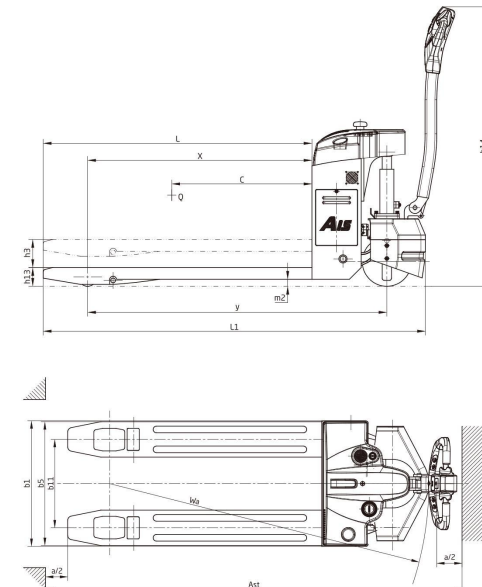



## A Series Pallet Truck Basic Range

with capacities of 2,000kg

### High Performance

- / AC travelling motor applied to provide excellent acceleration, good gradeability, low heat, no carbon brush and maintenance free.
- / The latest CURTIS AC control system provides accurate and stable control to work more efficient.
- / The applied CANBUS structure to offer more reliable and faster command access.
- / Regenerative brake and slope anti-slide function are offered by this truck.

### Comfort

- / The shock absorption design of foldable platform improves comfort greatly to the operator.
- / Simple and beautiful tiller designed to operate all functions easily even by one hand.
- / Displayed turtle speed function applied to move slowly and helps to stack goods in narrow spaces.
- / Optimized designing structure to offer a good visibility and easy entrance of the pallet.
- / The compact body and big rounded design provide an ideal operation in limited space, and the wedge designed chassis greatly increases the passing ability.

### Reliability

- / Five-pivot with low centre of gravity design and high strength steel frame structure chassis provide larger residual load capability and longer working life.
- / Water-proof plugs and connectors applied to provide a reliable protection to electric system.
- / The adopted unique floating suspension system ensures good driving wheels' grip and excellent stability.
- / Top quality hydraulic power unit applied to provide low noise, low vibration, smooth lifting and landing reliable operation.
- / Punch-formed forks to provide more strength and tip guide to provide higher efficient operation.
- / The power plug is fixed on the truck body to avoid damage from battery installment.

### Safety

- / With three braking types: releasing brake, reversing brake and emergency brake, the driving safety has been ensured.
- / The applied slope anti-slip function ensures the safety of the operation.
- / The emergency button on the tiller head can effectively avoid the harm to the driver.
- / The standard equipped electronic lifting limitation and intellectual control limitation to offer double protection to working motor and loads from damaging.



### Standard Specification

- |                            |  |
|----------------------------|--|
| / Horn                     | / Hydraulic power unit                 |
| / Pedal (only CBD20-AEC1S) | / 540mm outside fork width             |
| / AC drive wheel           | / Electronic lifting limitation        |
| / Tandem load wheels       | / Emergency disconnect switch          |
| / 1150mm fork length       | / Multi-function battery indicator     |
| / CURTIS AC controller     | / CAN-bus system multi-function tiller |

### Options

- / Load backrest
- / Guide roller of pallet
- / Handrail
- / 210Ah, 240Ah, battery
- / Different outside fork width (560mm, 600mm, 650mm, 680mm, 700mm)
- / Cold store protection (-30 C)
- / Different length of forks (1220mm, 1400mm, 1600mm, 2000mm, 2150mm, 2400mm)



Stand-on

## A Series Pallet Truck Basic Range

Distinguishing mark	HANGCHA GROUP CO.,LTD.				
	1.1	Manufacturer			
1.2	Manufacturer's type designation		CBD20-AEC1S	CBD20-AEC1	
1.4	Operator type: hand, pedestrian, standing, seated, order-picker		Standing	Pedestrian	
1.5	Rated capacity/rated load	Q (kg/lb)	2000/4409	2000/4409	
1.6	Load centre distance	c (mm/in)	600/23.6	600/23.6	
1.9	Wheelbase	y (mm/in)	1415/55.7	1415/55.7	
Weight	2.1	Service Weight	kg/lb	540/1190	490/1080
Tyres, chassis	3.1	Tyres: solid rubber, superelastic, pneumatic, polyurethane		PU	PU
	3.2	Tyre size, front	mm/in	φ250x80/9.8x3.1	φ250x80/9.8x3.1
3.3	Tyre size, rear	mm/in	φ85x703.3x2.8	φ85x703.3x2.8	
3.4	Additional wheel (dimensions)	mm/in	φ100x40/3.9x1.6	φ100x40/3.9x1.6	
3.5	Wheels, number front / rear (x = driven wheels)		1x+2/4	1x+2/4	
3.6	Tread, front	b <sub>50</sub> (mm/in)	534/21	534/21	
3.7	Tread, rear	b <sub>51</sub> (mm/in)	370/14.6	370/14.6	
Dimensions	4.4	Lift	h <sub>3</sub> (mm/in)	125/4.9	125/4.9
	4.15	Fork height, lowered	h <sub>13</sub> (mm/in)	85/3.3	85/3.3
	4.19	Overall length	l (mm/in)	1820(2252)/71.7(88.7)	1770/69.7
	4.21	Overall width	b <sub>1</sub> (mm/in)	750/29.5	750/29.5
	4.22	Fork dimensions ISO 2331	s/e/l (mm/in)	64x170x1150(2.5x6.7x45.3)	64x170x1150(2.5x6.7x45.3)
	4.25	Distance between fork-arms	b <sub>5</sub> (mm/in)	540/680(21.3/26.8)	540/680(21.3/26.8)
	4.32	Ground clearance, center of wheelbase	m <sub>2</sub> (mm/in)	25/1	25/1
	4.34.1	Aisle width for pallets 1000 x 1200 crossways	A <sub>st</sub> (mm/in)	1967/77.4	1902/74.9
	4.34.2	Aisle width for pallets 800 x 1200 lengthways	A <sub>st</sub> (mm/in)	2017/79.4	1952/76.9
	4.35	Turning radius	W <sub>a</sub> (mm/in)	1597/62.9	1532/60.3
Performance data	5.1	Travel speed, laden/unladen	km/h(mph)	5.0/5.0(3.1/3.1)	5.0/5.0(3.1/3.1)
	5.2	Lift speed, laden/unladen	m/s(ft/min)	0.030/0.045(5.9/8.9)	0.030/0.045(5.9/8.9)
	5.3	Lowering speed, laden/unladen	m/s(ft/min)	0.050/0.035(9.8/6.9)	0.050/0.035(9.8/6.9)
	5.8	Max. Gradeability, laden/unladen	%	6/15	6/15
	5.10	Service brake		Electromagnetic	Electromagnetic
	Electric engine	6.1	Drive motor rating S2 60 min	kw/hp	1.1/1.5
6.2		Lift motor rating at S3 15%	kw/hp	0.8/1.1	0.8/1.1
6.4		Battery voltage, rated capacity	V/Ah	24/165	24/165
8.1		Type of drive control		AC	AC
9.1		Manufacturer		CURTIS	CURTIS

Note: 1) When fork lowered, +68mm/+2.68in  
2) When fork lowered, +40mm/+1.57in

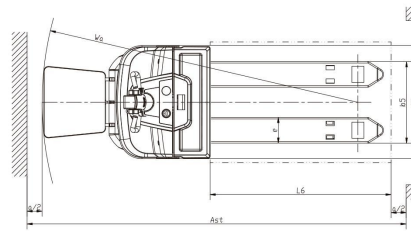
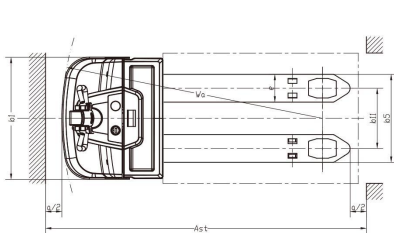
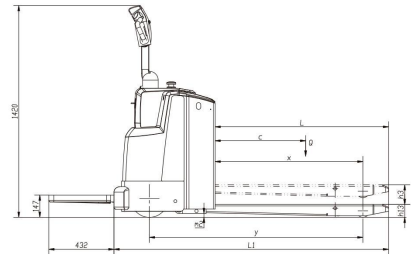
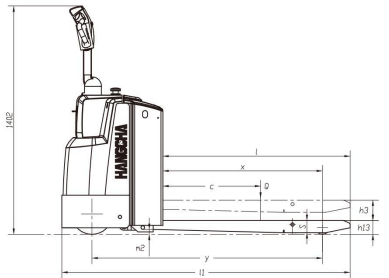

## A Series Pallet Truck Hi Range

with capacities of 2,000 to 3,000kg

## High Performance

- / AC travelling motor applied to provide excellent acceleration, good gradeability, low heat, no carbon brush and maintenance free.
- / The latest CURTIS AC control system provides accurate and stable control to work more efficient.
- / The applied CAN-BUS structure to offer more reliable and faster command access.
- / Regenerative brake and slope anti-slide function are offered by this truck.
- / Stand-on type with high power drive motor, provides fast travel speed and good gradeability.

## Reliability

- / Five-pivot with low centre of gravity design and high strength steel frame structure chassis provide larger residual load capacity and longer working life.
- / Water-proof plugs and connectors applied to provide a reliable protection to electric system.
- / The adopted unique floating suspension system ensures good driving wheels grip and excellent.
- / Top quality hydraulic power unit applied to provide low noise, low vibration, smooth lifting and landing reliable operation.
- / Punch-formed forks to provide more strength and tip guide to provide higher efficient operation.
- / H-type mast profile section to provide more stable and rigid performance.
- / The power plug is fixed on the truck body to avoid damage from battery installation.
- / Pedestrian type use the new design drive system, the drive motor will not accompany the tiller rotation, it can keep all the cable connect to the drive motor avoid being bent.
- / Using non-contact proximity switch, it can provides long life and reliable operation.

## Safety

- / With three braking types: releasing brake, reversing brake and emergency brake, the driving safety has been ensured.
- / The applied slope anti-slip function ensures the safety of the operation.
- / The emergency button on the tiller head can effectively avoid the harm to the driver.
- / Lifting limitation switch to offer protection to the loads from damaging.
- / Turning speed is automatically reduced when steering only for stand-on.
- / Turtle speed function can keep the slow move when the tiller is vertical direction, the truck can stack goods even in narrow space.

## Comfort

- / The shock absorption design of foldable platform improves comfort greatly to the operator.
- / The new designed floating suspension driving system, adjustable automatically with loads, offers the driving wheels sufficient power.
- / Simple and beautiful tiller designed to operate all functions easily even by one hand.
- / Displayed turtle speed function applied to move slowly and helps to stack goods in narrow spaces.
- / Optimized designing structure to offer a good visibility and easy entrance of the pallet.
- / The compact body and big rounded design provide an ideal operation in limited space, and the wedge designed chassis greatly increases the passing ability.
- / Customer can choose different width of outside fork and length of forks to fit variable pallet.

## Maintenance

- / AC motor with no cabin brush, don't need maintenance, lower cost.
- / Rear cover can be completely open, operator can see all the components, so the maintenance is very convenient.
- / All shafts installed lubricated shaft sleeve and oil cup, provide convenient maintenance and long service life.

## Standard Specification

- / Horn
- / AC drive motor
- / PU drive wheel
- / Pedal and handrail
- / Tandem load wheels
- / 1150mm fork length
- / CURTIS AC controller
- / Hydraulic power unit
- / 540mm outside fork width
- / Electronic lifting limitation
- / Emergency disconnect switch
- / Multi-function battery indicator
- / CAN-bus system multi-function tiller
- / Electric steering (stand on pallet)

## Options

- / Different length of forks
- / Different width of outside fork
- / Cold store protection (-30°C)
- / Pedestrian: 210Ah~240Ah
- / Stand-on: 240Ah~340Ah
- / Guide roller of pallet
- / Load backrest
- / Automatic charger



## A Series Pallet Truck Hi Range

Distinguishing mark	1.1	Manufacturer	HANGCHA GROUP CO.,LTD.				
			CB020-AC1S	CB020-AC1	CB030-AC1S	CB030-AC1	
1.2	Manufacturer's type designation		CB020-AC1S	CB020-AC1	CB030-AC1S	CB030-AC1	
1.4	Operator type: hand, pedestrian, standing, seated, order-picker		Standing	Pedestrian	Standing	Pedestrian	
1.5	Rated capacity/rated load	Q (kg)/(lb)	2000/4409	2000/4409	3000/6614	3000/6614	
1.6	Load centre distance	c (mm/in)	600/23.6	600/23.6	600/23.6	600/23.6	
1.9	Wheelbase	y (mm/in)	1369/53.9 <sup>1)</sup>	1357/53.4 <sup>1)</sup>	1369/53.9 <sup>1)</sup>	1357/53.4 <sup>1)</sup>	
Weight	2.1	Service Weight	kg/lb	726/1600	544/1199	750/1654	564/12434
Tyres, chassis	3.1	Tyres: solid rubber, superelastic, pneumatic, polyurethane		PU	PU	PU	PU
	3.2	Tyre size, front	mm/in	Φ230x75/Φ9.1x3.0	Φ230x75/Φ9.1x3.0	Φ230x75/Φ9.1x3.0	Φ230x75/Φ9.1x3.0
	3.3	Tyre size, rear	mm/in	Φ85x70/Φ3.3x2.8	Φ85x70/Φ3.3x2.8	Φ85x70/Φ3.3x2.8	Φ85x70/Φ3.3x2.8
	3.4	Additional wheel (dimensions)	mm/in	Φ125x50/Φ4.9x2.0	Φ100x40/Φ3.9x1.6	Φ125x50/Φ4.9x2.0	Φ100x40/Φ3.9x1.6
	3.5	Wheels, number front / rear (x = driven wheels)		1x+2/4	1x+2/4	1x+2/4	1x+2/4
	3.6	Tread, front	b <sub>10</sub> (mm/in)	575/22.6	480/18.9	575/22.6	480/18.9
	3.7	Tread, rear	b <sub>11</sub> (mm/in)	370/14.6	370/14.6	370/14.6	370/14.6
Dimensions	4.4	Lift	h <sub>1</sub> (mm/in)	125/4.9	125/4.9	125/4.9	125/4.9
	4.15	Fork height/lowered	h <sub>2</sub> (mm/in)	85/3.35	85/3.35	85/3.35	85/3.35
	4.19	Overall length	l <sub>1</sub> (mm/in)	1867/73.5	1781/70.1	1867/73.5	1781/70.1
	4.21	Overall length(unfold the pedal)	l <sub>2</sub> (mm/in)	2299/90.5		2299/90.5	
	4.22	Overall width	b (mm/in)	800/31.5	750/29.5	800/31.5	750/29.5
	4.25	Fork dimensions ISO 2331	s/e/l mm/in(in)	64/170/1150 (2.5/6.7/45.2)	64/170/1150 (2.5/6.7/45.2)	64/170/1150 (2.5/6.7/45.2)	64/170/1150 (2.5/6.7/45.2)
	4.25	Distance between fork-arms	b <sub>8</sub> mm/in(in)	540/680 (21.3/26.8)	540/680 (21.3/26.8)	540/680 (21.3/26.8)	540/680 (21.3/26.8)
	4.32	Ground clearance,center of wheelbase	m <sub>2</sub> (mm/in)	25/0.98	25/0.98	25/0.98	25/0.98
	4.34.1	Aisle width for pallets 1000 x 1200 crossways	A <sub>st</sub> (mm/in)	1997/78.6 <sup>2)</sup>	1955/77 <sup>2)</sup>	1997/78.6 <sup>2)</sup>	1955/77 <sup>2)</sup>
	4.34.2	Aisle width for pallets 800 x 1200 lengthways	A <sub>st</sub> (mm/in)	2047/80.6 <sup>2)</sup>	2005/78.9 <sup>2)</sup>	2047/80.6 <sup>2)</sup>	2005/78.9 <sup>2)</sup>
4.35	Turning radius	W <sub>a</sub> (mm/in)	1627/2040 <sup>1)</sup> (64.1/80.3)	1585 <sup>1)</sup> (62.4)	1627/2040 <sup>1)</sup> (64.1/80.3)	1585 <sup>1)</sup> (62.4)	
Performance data	5.1	Travel speed,laden/unladen	km/h(mph)	9.0/9.5 (5.6/5.9)	6.0/6.0 (3.7/3.7)	7.5/9.5 (4.7/5.9)	5.0/6.0 (3.1/3.7)
	5.2	Lift speed,laden/unladen	m/s (ft/min)	0.047/0.085 (9.3/12.8)	0.047/0.085 (9.3/12.8)	0.036/0.051 (7.1/10.0)	0.036/0.051 (7.1/10.0)
	5.3	Lowering speed,laden/unladen	m/s (ft/min)	0.075/0.070 (1.4/8.1/3.8)	0.073/0.070 (1.4/4.1/3.0)	0.060/0.055 (1.1/8.1/0.8)	0.060/0.055 (1.1/8.1/0.8)
	5.8	Max.Gradeability,laden/unladen	%	10/16	8/20	8/16	6/20
Electric engine	6.1	Drive motor rating S2 60 min	kw/hp	2.2/3.0	1.5/2.0	2.2/3.0	1.5/2.0
	6.2	Lift motor rating at S3 15%	kw/hp	2.2/3.0	2.2/3.0	2.2/3.0	2.2/3.0
	6.4	Battery voltage,rated capacity	V/Ah	24/240	24/210	24/280	24/240
		Battery voltage,rated capacity,Optional	V/Ah	-24/340	-24/240	-24/340	-24/240
8.1	Type of drive control		AC	AC	AC	AC	
9.1	Manufacturer		CURTIS	CURTIS	CURTIS	CURTIS	

Note: 1) When fork lowered,+68mm+2.68in 2) When fork lowered,+40mm+1.57in

ZAPI controller is as option with model CB020-AC3,CB030-AZ3,CB020-AZ3S,CB030-AZ3S

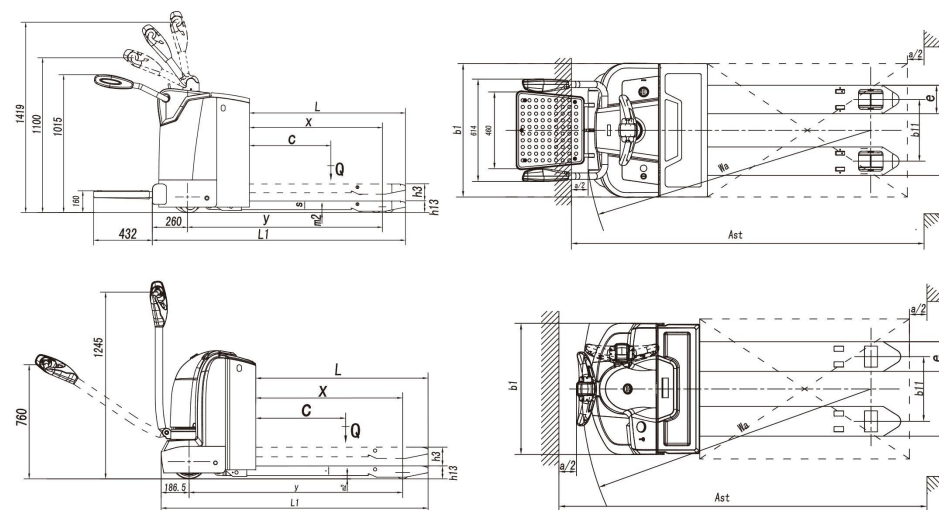

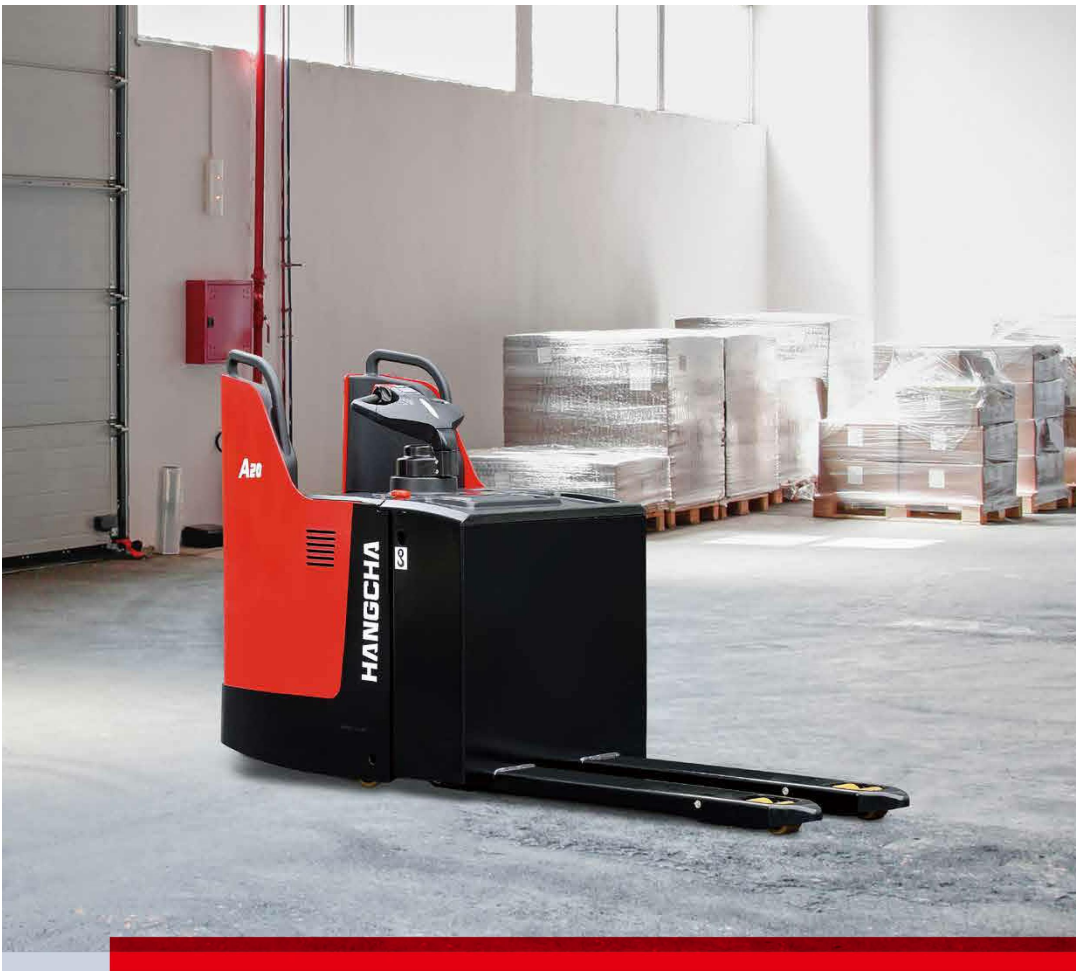

## A Series Rider Pallet Truck

with capacities of 2,000 to 3,000kg

The rider pallet truck is one of the A series pallet truck models. Using the latest AC drive technology, advanced performance, comfort, safe, reliable, low maintenance cost, is the ideal tool for heavy duty and long distance transport operations.

### Appearance

- / A series electric rider pallet truck applied professional industrial design, stream lines, and compact, and fully ergonomic consideration, in line with the latest design trends.
- / Applied steel stamping and injection molding processes for front and back guard, which is robust, durable, and also environmental compliance.

### High Performance

- / Electric power steering (EPS) is standard specification, which provides flexible operation.
- / Powered by AC traction motor not only has good acceleration and climbing performance, but also low heat, brushless, maintenance-free.
- / Latest AC CURTIS control system, precise and smooth.
- / CAN-BUS connection enables all truck data can be read out for inspection, and also improves the data transition more quick and reliable.
- / Regenerative braking for battery recovery during travel speed reduction, anti-slope on gradient.
- / All key parts such as switches, connectors, battery indicator and hour meter all adopt the famous brand.

### Safety

- / Automatic deceleration during turning.
- / Punch-formed frame provide more safety to the operator.
- / Three braking system of regenerative braking, reverse current braking, parking brake, insures the safe operation.
- / Anti-slope on gradient can keep the safety.
- / The braking button on the tiller head can effectively avoid the harm to the driver.
- / The standard equipped electronic lifting limitation protect the pump motor from damaging dramatically and more energy saving.
- / Displayed turtle speed function applied to move slowly and helps to stack goods in narrow space.

### Maintenance

- / AC motor without carbon brushes, maintenance-free, cost saving.
- / Integrated battery indicator, hour meter and self-diagnostic instrument.
- / Full opened hood, easy accessibility of all components, is easy for service.
- / All shafts installed lubricated shaft sleeve and oil cup, provide convenient maintenance and long service life.



The pedal applies shock absorption design, greatly improve the operator's comfort, reduce the fatigue



Optimized designing structure to offer a good visibility and easy entrance of the pallet



Side battery change is standard feature



Simple and beautiful tiller designed to make the operator feel comfortable, all the operation can be completed by one hand

5-pivot with low centre of gravity design and high strength steel frame structure chassis provide larger residual load capability and longer working life.

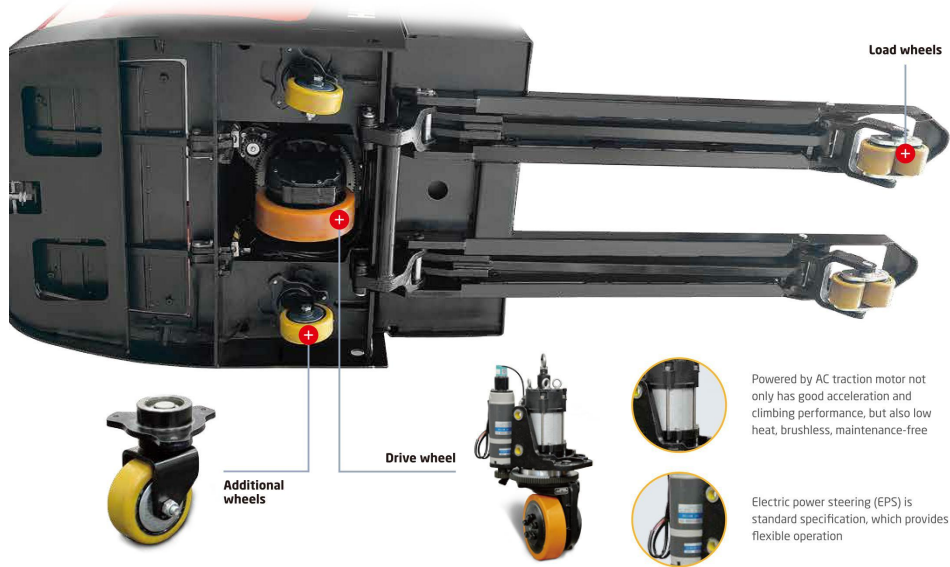

Powered by AC traction motor not only has good acceleration and climbing performance, but also low heat, brushless, maintenance-free

Electric power steering (EPS) is standard specification, which provides flexible operation

## Reliability

- / Adopted unique floating suspension system ensures good driving wheels' grip and excellent stability.
- / Imported waterproof connectors, all wires and cables are protected, greatly improve the reliability of the electric system. Using non-contact proximity switch, improves safety and reliability.
- / Top quality hydraulic power unit applied to provide low noise, low vibration, smooth lifting and landing reliable operation.
- / Punch formed forks to provide more strength and tip guide to provide higher efficient operation.
- / The power plug is fixed on the truck body to avoid damage from battery installment.

## Comfort

- / Smooth driving and more comfortable operating experience thanks to a new design of the floating drive suspension system.
- / The compact body and semicircular design provide an ideal operation in limited space, and the wedge designed chassis greatly increases the passing ability.

## Standard Specification

- / AC drive motor
- / CURTIS AC controller
- / Electric Power Steering (EPS)
- / Emergency switch
- / 1150mm fork length
- / Side battery change
- / Multi-function battery indicator
- / CAN-bus technology
- / 540mm outside fork width
- / Automatic speed reduction when cornering
- / Imported hydraulic unit
- / Brake switch

## Options

- / Different length of fork
- / Different capacity of battery

## A Series Rider Pallet Truck

Distinguishing mark	HANGCHA GROUP CO.,LTD.						
	CBD20-ABC15-SU	CBD20-AC15-SU	CBD30-ABC15-SU	CBD30-AC15-SU			
1.1	Manufacturer						
1.2	Manufacturer's type designation						
1.3	Drive: electric (battery or mains), diesel, petrol, fuel gas						
1.4	Operator type: hand, pedestrian, standing, seated, order-picker						
1.5	Rated capacity/rated load	Q (kg/lb)	2000/4409	2000/4409	3000/6614	3000/6614	
1.6	Load centre distance	c (mm/in)	600/23.6	600/23.6	600/23.6	600/23.6	
1.9	Wheelbase	y (mm/in)	1505/59.3	1505/59.3	1505/59.3	1505/59.3	
Weight	2.1	Service Weight	kg/lb	825/1819	880/1940	880/1940	920/2028
Tyres, chassis	3.1	Tyres: solid rubber, superelastic, pneumatic, polyurethane	PU	PU	PU	PU	
	3.2	Tyre size, front	mm/in	ø85*80 / 3.3*3.1	ø85*80 / 3.3*3.1	ø85*80 / 3.3*3.1	ø85*80 / 3.3*3.1
3.3	Tyre size, rear	mm/in	ø230*75 / 9.1*3	ø230*75 / 9.1*3	ø230*75 / 9.1*3	ø230*75 / 9.1*3	
3.4	Additional wheels (dimensions)	mm/in	ø125*50 / 4.9*2	ø125*50 / 4.9*2	ø125*50 / 4.9*2	ø125*50 / 4.9*2	
3.5	Wheels, number front / rear (x = driven wheels)		1**2/4	1**2/4	1**2/4	1**2/4	
3.6	Tread, front	b <sub>0</sub> (mm/in)	575/22.6	575/22.6	575/22.6	575/22.6	
3.7	Tread, rear	b <sub>11</sub> (mm/in)	370/14.6	370/14.6	370/14.6	370/14.6	
4.3	Free lift	h <sub>2</sub> (mm/in)	125/4.9	125/4.9	125/4.9	125/4.9	
Dimensions	4.19	Overall length	l <sub>1</sub> (mm/in)	2372/93.4	2372/93.4	2372/93.4	2372/93.4
	4.21	Overall width	b <sub>1</sub> (mm/in)	800/31.5	800/31.5	800/31.5	800/31.5
	4.22	Fork dimensions ISO 2331	s/e/ mm/(in)	60/20/110 (2.56/7.45)	60/20/110 (2.56/7.45)	60/20/110 (2.56/7.45)	60/20/110 (2.56/7.45)
	4.25	Distance between fork-arms	b <sub>s</sub> mm/(in)	540/680 (21.3/26.8)	540/680 (21.3/26.8)	540/680 (21.3/26.8)	540/680 (21.3/26.8)
	4.31	Ground clearance, laden, below mast	m <sub>1</sub> (mm/in)	21/0.8	21/0.8	21/0.8	21/0.8
	4.34.1	Aisle width for pallets 1000 x 1200 crossways	A <sub>st</sub> (mm/in)	2504 <sup>1)</sup> /98.6	2504 <sup>1)</sup> /98.6	2504 <sup>1)</sup> /98.6	2504 <sup>1)</sup> /98.6
	4.34.2	Aisle width for pallets 800 x 1200 lengthways	A <sub>st</sub> (mm/in)	2554 <sup>2)</sup> /100.6	2554 <sup>2)</sup> /100.6	2554 <sup>2)</sup> /100.6	2554 <sup>2)</sup> /100.6
	4.35	Turning radius	W <sub>a</sub> (mm/in)	2134 <sup>3)</sup> /84	2134 <sup>3)</sup> /84	2134 <sup>3)</sup> /84	2134 <sup>3)</sup> /84
	5.1	Travel speed, laden/unladen	km/h (mph)	6.5/7.0 (4/4.3)	9.0/9.5 (5.6/5.9)	5.5/7.0 (3.4/4.3)	7.5/9.5 (4.7/5.9)
	5.2	Lift speed, laden/unladen	m/s (ft/min)	0.047/0.064 (9.2/12.6)	0.047/0.064 (9.2/12.6)	0.036/0.053 (7.1/10.4)	0.036/0.053 (7.1/10.4)
5.3	Lowering speed, laden/unladen	m/s (ft/min)	0.075/0.071 (14.8/13.8)	0.075/0.071 (14.8/13.8)	0.060/0.058 (11.8/11.4)	0.060/0.058 (11.8/11.4)	
5.8	Max. gradeability, laden/unladen	%	5/16	8/16	5/16	8/16	
5.10	Service brake		Electromagnetic	Electromagnetic	Electromagnetic	Electromagnetic	
Electric engine	6.1	Drive motor rating S2 60 min	kw/hp	1.5/2.0	2.2/3.0	1.5/2.0	2.2/3.0
	6.2	Lift motor rating at 53 15%	kw/hp	DC 2.2/3.0	DC 2.2/3.0	DC 2.2/3.0	DC 2.2/3.0
	6.4	Battery voltage, nominal capacity K5	V/Ah	24/240	24/280	24/280	24/340
		Battery voltage,rated capacity,Optional	V/Ah	24/-340	24/-340	24/-340	-
8.1	Type of drive unit		AC traction	AC traction	AC traction	AC traction	
9.1	Manufacturer/Type		CURTIS	CURTIS	CURTIS	CURTIS	
10.7	Sound pressure level at the driver's seat	dB (A)	≤75	≤75	≤75	≤75	

Note: 1) VDI 2198: +430mm (+16.9in) 2) VDI 2198: +236mm(+9.3in) 3) When fork lowered,+68mm(+2.7in)  
ZAPI controller is as option with model CBD20-AZ35-SU,CBD30-AZ35-SU

